



**DIESSA**

[www.diessa.es](http://www.diessa.es)

Excellence beyond quality



**MAN CATALOGUE**



model	page
TGA XLX-XXL	05
TGA M-L-LX	13
M/F2000	19
TG-L 8.180	23
TG-X	29
TG-S	35
TG-S OBRA	41
TG-X EURO 6	43
TG-S EURO 6	47
TG-L EURO 6	51
TG-M EURO 6	55





91416100281P



The parts referenced in this catalog are not original, but are perfectly adaptable to the models to which they are intended. The use of the manufacturers' marks and the original references is done exclusively for the purpose of indicating the model to which each piece is destined.



The parts referenced in this catalog are not original, but are perfectly adaptable to the models to which they are intended. The use of the manufacturers' marks and the original references is done exclusively for the purpose of indicating the model to which each piece is destined.



# TGA XLX-XXL



D0500052



D0500050



D0500053

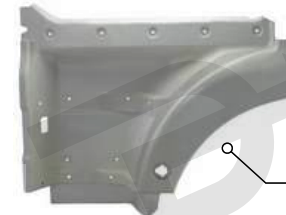

D0500051

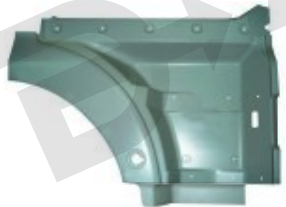

DM2.0399



D0600458



D0600461



D0700144



D0600459



DM2.0400

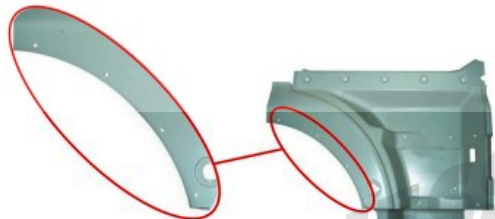

DM2.0401



DM0.2537



DM2.0402



DM2.0360



D0600462



DM2.0330



D0600463



DM2.0331



DM2.0403

The parts referenced in this catalog are not original, but are perfectly adaptable to the models to which they are intended. The use of the manufacturers' marks and the original references is done exclusively for the purpose of indicating the model to which each piece is destined.



D0500055



DC2.2979



DM0.2135



D0500060



DM2.0061



D0500371



DM2.0065



D0500058



D0600464



DM2.0356



D0600451



DC0.0804



DM2.0308



DC0.0804



DM2.0066



D0500054

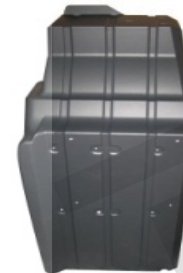

DC0.0805



DM2.0307



DC0.0805

The parts referenced in this catalog are not original, but are perfectly adaptable to the models to which they are intended.  
The use of the manufacturers' marks and the original references is done exclusively for the purpose of indicating the model to which each piece is destined.





D0500387



D0500386



DE0.0140

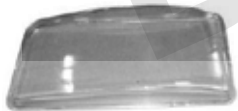

DE0.0142

DE0.0141



DM2.0288

DE0.0139



D0700168



D0700169



D0600573



DC0.0621



D0600572



D0700165



DM2.0071



DE0.0149



DE0.0148



DM0.2401



D0500126



DM2.0241



DM2.0113



DE0.0146



DM2.0109



DM2.0110



DE0.0147



DM2.0114

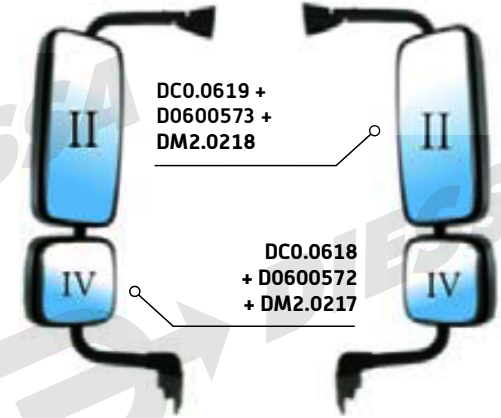

DC0.0619 +  
D0600573 +  
DM2.0218

DC0.0618  
+ D0600572  
+ DM2.0217

The parts referenced in this catalog are not original, but are perfectly adaptable to the models to which they are intended. The use of the manufacturers' marks and the original references is done exclusively for the purpose of indicating the model to which each piece is destined.

DIESSA REF.	O.E.M. REF.	DESCRIPTION
D0500194	8161110053,81611100047,81611100053	FR PANEL (XXL-XL)
D0600455	81611505066,81611506050,81062016020	GRILLE (XXL-XL)
D0600445	81624100046	INNER CORNER VANE, RH --->2006
D0600446	81624100047	INNER CORNER VANE, LH --->2006
DM0.2139	81624100092	CORNER VANE INNER RH
DM0.2136	81624100089	CORNER VANE LH
D0600447	81624100048	CORNER VANE, RH --->2006
D0600448	81624100049	CORNER VANE, LH --->2006
DM0.2137	81624100090	CORNER VANE RH
DM0.2138	81624100091	CORNER VANE INNER LH
DC0.1073CZ	81416100305,81416100238,81416100405	FR BUMPER (WHITE) (XXL)
DC0.0815	81416100228IP	BUMPER COVER (WHITE), RH (XXL)
DC0.0814	81416100227IP	BUMPER COVER (WHITE), LH (XXL)
D0500045CZ	81416100306,81416100222	BUMPER (BLK) (XXL)
DC0.0917	81416100228	BUMPER COVER (BLK), RH (XXL)
DC0.0918	81416100227	BUMPER COVER (BLK), LH (XXL)
DM0.9991	81416100232	SIDE BUMPER COVER, RH
D0700051	81416100231	SIDE BUMPER COVER, LH
D0600443	81416102882	UPPER STEPBOARD, BUMPER
DC0.0810	81416102881	LOWER STEPBOARD, BUMPER
DC0.0812	81416850040,81416850055	BUMPER COVER (SQU)
DC0.0811	81416850031,81416850056	BUMPER COVER (SQU)
DM2.0184	81626416080	OUTSIDE HANDLE W/KEY SET, FRONT RH
DM0.2461	81626416081,81626416075,81626800129	OUTSIDE HANDLE W/KEY SET, FRONT LH
DM2.0185	81626416068	INSIDE HANDLE, FRONT RH
DM2.0051	81626416067	INSIDE HANDLE, FRONT LH
D0600453	81626100018	DOOR EXTENTION (DARK-GREY), RH (XXL)
D0600452	81626100019	DOOR EXTENTION (DARK-GREY), LH (XXL)
DC2.3314	81626100024,81626100040	DOOR EXTENTION (WHITE), RH (XXL)
DC2.3313	81626100023	DOOR EXTENTION (WHITE), LH (XXL)
D0600461	81416850044,81416850053	CENTRAL GRILLE

DIESSA REF.	O.E.M. REF.	DESCRIPTION
D0700144	81637010046,81637010031	SUN VISOR HIGH ROOF 2170mm
DM0.2537	81637010057	SUN VISOR 2210 mm
D0500052	81615100400,81615100704,81615100280	FOOTSTEP MUDGUARD (GREY), RH
D0500053	81615100399,81615100703,81615100281	FOOTSTEP MUDGUARD (GREY), LH
D0500050	81615100402,81615100332,81615100706	FOOTSTEP MUDGUARD (MAT-WHITE), RH
D0500051	81615100401,81615100331,81615100405	FOOTSTEP MUDGUARD (MAT-WHITE), LH
DM2.0399	81615100834,81615100924,81615100542	FR MUDGUARD, RH
DM2.0400	81615100835,81615100923,81615100543	FR MUDGUARD, LH
DM2.0401	81615100838,81615100928,81615100627	FR MUDGUARD W/HOLE, RH
DM2.0402	81615100839,81615100927	FR MUDGUARD W/HOLE, LH
DM2.0360	81615100623,81615100710,81615100830	FENDER R
DM2.0403	81615100919	FENDER L
DM2.0358CZ	81615100374,81615100802,81615100334,81615100752	FOOT STEP (WHITE), RH
DM2.0357CZ	81615100373,81615100801,81615100333,81615100751	FOOT STEP (WHITE), LH
DC0.0922	81615100798,81615100752	FOOT STEP (BLACK), RH
DC0.0923	81615100797,81615100751	FOOT STEP (BLACK), LH
DC0.0829	81615100536,81615100443,81615100468	COVER, STEPWALL
D0600462	81664100204,81664100308,81664100312	MUDGUARD SIDE PANEL (WHITE), RH (XXL)
D0600463	81664100205,81664100309,81664100313	MUDGUARD SIDE PANEL (WHITE), LH (XXL)
DM2.0330	81664100306	MUDGUARD SIDE PANEL (GREY), RH
DM2.0331	81664100307	MUDGUARD SIDE PANEL (GREY), LH
D0500055	81664100294,81664100194	FR. RE MUDGUARD, RH
D0500060	81664100293,81664100299	FR. RE MUDGUARD, LH
D0500058	81664100172	RE, RHE MUDGUARD, RH
D0500061	81664100173	RE, RE MUDGUARD, LH

DIESSA REF.	O.E.M. REF.	DESCRIPTION
DC2.2979	81664106599	FR. RE MUDGUARD
DM2.0061	81664106608	FR. RE MUDGUARD
D0700178	81664106606	TOP MUDGUARD W/O STRIPE
DM2.0065	81664106607	TOP MUDGUARD W/O STRAPE
DM2.0066	81664106612	TOP MUDGUARD W/O STRAPE
D0600451	81664100226	RE TOP MUDGUARD (L=R)
D0500054	81664106086	RE TOP MUDGUARD W/O STRAPE (L=R)
DM2.0308	81612100676	FR MUDGUARD (SMALL WHEEL) GREY, RH
DM2.0307	81612100675,81664100181,81664100361	FR MUDGUARD (SMALL WHEEL) GREY, LH
DC0.0804	81612100684,81664100363	FR MUDGUARD (BIG WHEEL) GREY, RH
DC0.0805	81612100683,81612100681	FR MUDGUARD (BIG WHEEL) GREY, LH
DM2.0356	81664400192	RUBBER STRIPE 210mm
D0600451	81664100226	RUBBER STRIPE, RE TOP M/GUARD 145mm
DC0.0828	81615105187	LOWER STEP PANEL (R=L)
DC0.0919	81615100273	UPPER STEP PANEL (R=L) FOR TG-A XXL AND TGX
DE0.0141	81251016450,81251016454,81251016352,81251016422,81251016430	HEAD LAMP (W/MOTOR) RH H7/H7/W5W
DE0.0139	81251006451,81251016455,81251016351,81251016421	HEAD LAMP (W/MOTOR) LH H7/H7/W5W
D0700168	81251016448,81251016428,81251016593	HEAD LAMP (MANUAL) RH H7/H7/W5W
D0700169	81251016449,81251016427,81251016457	HEAD LAMP (MANUAL) LH H7/H7/W5W
DE0.0149	81253206092,81253206112	FOG LAMP (YELLOW), RH H4 P21W
DE0.0148	81253206091,81253206111	FOG LAMP (YELLOW), LH H4 P21W
DM2.0109	81253206114	FOG LAMP (CLEAR), RH H4/PY21W
DM2.0110	81253206113,81253206107	FOG LAMP (CLEAR), L H H4/PY21W
DE0.0144	81252256523,1357076,1625986	TAIL LAMP RH P21W/ P21W/P21W/P21W/R5W/R5W/R5W/R5W/R10W
DE0.0143	81252256524	TAIL LAMP LH P21W/ P21W/P21W/P21W/R5W/R5W/R5W/R5W/R10W
D0500126	81253206115,81253206117,81253206094	SIDE LAMP, YELLOW (R=L) AMBAR
DM2.0241	81253206118,81253206106	SIDE LAMP, CLEAR (R=L) PY21W
D0700165	81252606101,81252606096,81252606097	SIDE LAMP, (R=L) LED

DIESSA REF.	O.E.M. REF.	DESCRIPTION
DC0.0619	81637306481,81637306432	MAIN MIRROR RH CLASS II ELECTRIC HEATED R1200 LHD
DC0.0618	81637306480,81637306430	MAIN MIRROR LH CLASS II ELECTRIC HEATED R1200 LHD
D0600573	81637306513,81637306410	WIDE ANGLE MIRROR RH CLASS IV ELECTRIC. HEATED R300 LHD
D0600572	81637306512,81637306409	WIDE ANGLE MIRROR LH CLASS IV ELECTRIC. HEATED R300 LHD
DM2.0218	81637316560	MIRROR GLASS CLASS II RH=LH HEATED R1200 LHD
DM2.0217	81637316557	MIRROR GLASS CLASS IV WIDE ANGLE RH=LH HEATED R300 LHD
DC0.0813	81416850041	BUMPER COVER
DM0.2140	81416850029,81416850057	BUMPER COVER (ROUND)
DC0.1578	81624400041	BUMPER COVER RH
DC0.1579	81624400039	BUMPER COVER LH
D0600458	81615100411	EXTENSION LH
D0600459	81615100378,81615100410	EXTENSION RH
D0500371	81418606090	BATTERY COVER
D0600464	81612100462	REAR MUDGUARD RH/LH
DM0.2135	81664106605,81664106625	RE, RE MUDGUARD
DC0.0901	81615110000,81615110001,81615100272	CENTRAL STEP PANEL (R=L)
DM2.0114	81252256545,81252256551	TAIL LAMP RH (W/SOCKET) P21W/P21W/P21W/PY21W/R10W/R5W/R5W
DM2.0113	81252256544,81252256550	TAIL LAMP LH (W/SOCKET) P21W/P21W/P21W/PY21W/R10W/R5W/R5W
DE0.0146	81253206089	LIGHT PILOT WITHOUT ANTI-FOG HEADLIGHT LH
DE0.0147	81253206090	LIGHT PILOT WITHOUT ANTI-FOG HEADLIGHT RH
DE0.0142	81251100081	HEADLIGHT GLASS RH
DE0.0140	81251100080	HEADLIGHT GLASS LH
DM0.2077	81637320057	MIRROR COVER LH
DM0.2359	81637320056	MIRROR COVER RH
D0500386	81637320055	BACK COVER MIRROR II RH
D0500387	81637320054	BACK COVER MIRROR II LH
DM2.0071	81637310261	BACK COVER MIRROR LH
DM0.2401	81637310260	BACK COVER MIRROR RH





DM0.2139



D0600445



D0600446



DM0.2138



D0600447



DM0.2137



D0500196



DM0.2136



D0600448



DC0.0845



DC0.0808



D0600469

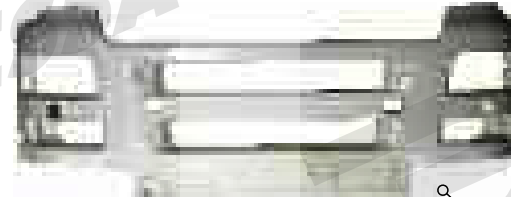

DC0.0806



DC0.0807

The parts referenced in this catalog are not original, but are perfectly adaptable to the models to which they are intended. The use of the manufacturers' marks and the original references is done exclusively for the purpose of indicating the model to which each piece is destined.





DM2.0184



DM2.0185



DC0.0841



DM0.2489



DM2.0201



DM2.0108



DC0.0812



DC0.0773



DM0.1818



D0700144



D0600461



DC0.0769



DM0.2461



DM2.0051



DC0.0840



DM0.2488



DM2.0202



DC0.0811

The parts referenced in this catalog are not original, but are perfectly adaptable to the models to which they are intended. The use of the manufacturers' marks and the original references is done exclusively for the purpose of indicating the model to which each piece is destined.



DM2.0326



DM2.0327



DM2.0328



DM2.0329



DCO.0828



DCO.0901



DCO.0829



D0500398



DCO.0919



D0500399



DCO.0804



DCO.0827



DCO.0830



DCO.0805

The parts referenced in this catalog are not original, but are perfectly adaptable to the models to which they are intended. The use of the manufacturers' marks and the original references is done exclusively for the purpose of indicating the model to which each piece is destined.

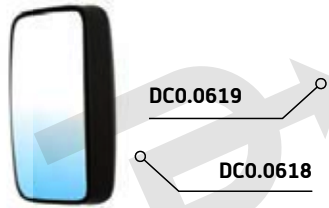

DC0.0619

DC0.0618



DM0.2077



DM0.2359



DE0.0140



DE0.0142



D0700165



DM2.0071



DE0.0149



DE0.0148



DM0.2401



D0500126



DM2.0241



DM2.0113



DE0.0146



DM2.0109



DM2.0110



DE0.0147



DM2.0114

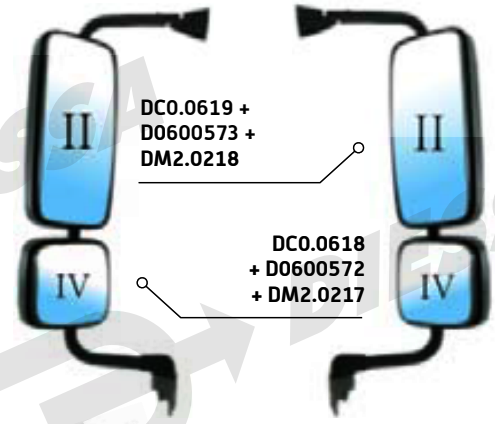

DC0.0619 +  
D0600573 +  
DM2.0218

DC0.0618  
+ D0600572  
+ DM2.0217



DM2.0288



D0600573



DE0.0139



D0600572



DE0.0141



DE0.0139



D0700168



D0700169

The parts referenced in this catalog are not original, but are perfectly adaptable to the models to which they are intended.  
The use of the manufacturers' marks and the original references is done exclusively for the purpose of indicating the model to which each piece is destined.



DIESSA REF.	O.E.M. REF.	DESCRIPTION
D0500196	81611100063, 81611100054	FR PANEL (M-L-XL)
DC0.0845	81611505068, 81611506049, 81611506051	GRILLE (M-L-LX)
D0600445	81624100046	INNER CORNER VANE, RH -->2006
D0600446	81624100047	INNER CORNER VANE, LH -->2006
DM0.2139	81624100092	CORNER VANE INNER RH
DM0.2138	81624100091	CORNER VANE INNER LH
D0600447	81624100048	CORNER VANE, RH -->2006
D0600448	81624100049	CORNER VANE, LH -->2006
DM0.2137	81624100090	CORNER VANE RH
DM0.2136	81624100089	CORNER VANE LH
DC0.0806	81416100237, 81416100307	BUMPER (WHITE) (LX)
DC0.0808	81416100226	BUMPER COVER (BLK), RH (LX)
DC0.0807	81416100225	BUMPER COVER (BLK), LH (LX)
D0600469	81416100221, 81416100308	BUMPER (BLK) (LX)
DM0.2489	81416105598	STEEL SIDE BUMPER, RH
DM0.2488	81416105597	STEEL SIDE BUMPER, LH
DM2.0201	81416100230	SIDE BUMPER COVER, RH
DM2.0202	81416100229	SIDE BUMPER COVER, LH
DC0.0812	81416850040, 81416850055	BUMPER COVER (SQU)
DC0.0811	81416850031, 81416850056	BUMPER COVER (SQU)
DM2.0108	81960020466, 81960020491, 81960020497	BUMPER COVER (OVAL)
DM2.0184	81626416080	OUTSIDE HANDLE W/KEY SET, FRONT RH
DM0.2461	81626416081, 81626416075, 81626800129	OUTSIDE HANDLE W/KEY SET, FRONT LH
DM2.0185	81626416068	INSIDE HANDLE, FRONT RH
DM2.0051	81626416067	INSIDE HANDLE, FRONT LH
D0600461	81416850044, 81416850053	CENTRAL GRILLE
D0700144	81637010046, 81637010031	SUN VISOR HIGH ROOF 2170mm
DM0.1818	81637010060, 81637010047	SUN VISOR 2000mm
DM2.0326	81615100854, 81615100936, 81615100482	FENDER RH (WIDE)

DIESSA REF.	O.E.M. REF.	DESCRIPTION
DM2.0327	81615100853, 81615100585, 81615100587	FENDER LH (WIDE)
DM2.0328	82615100056	FENDER RH (NARROW)
DM2.0329	82615100055	FENDER LH (NARROW)
D0500398	81615100380, 81615100736	FOOTBOARD (BLK), RH (LX)
D0500399	81615100351, 81615100735	FOOTBOARD (BLK), LH (LX)
DC0.0827	81615100382, 81615100354	FOOTBOARD (WHITE), RH (LX)
DC0.0830	81615100355, 81615100679, 81615100739	FOOTBOARD (WHITE), L (LX)
DC0.0829	81615100536, 81615100443, 81615100468	COVER, STEPWALL
DC0.0804	81612100684, 81664100363, 81664100367	FR MUDGUARD (BIG WHEEL) GREY, RH
DC0.0805	81612100683, 81612100681	FR MUDGUARD (BIG WHEEL) GREY, LH
DC0.0828	81615105187	LOWER STEP PANEL (R=L)
DC0.0919	81615100273	UPPER STEP PANEL (R=L) FOR TG-A XXL AND TGX
DE0.0141	81251016450, 81251016579, 81251016352, 81251016422, 81251016430	HEAD LAMP (W/MOTOR) RH H7/H7/W5W
DE0.0139	81251006451, 81251016580, 81251016351, 81251016421	HEAD LAMP (W/MOTOR) LH H7/H7/W5W
D0700168	81251016448, 81251016428, 81251016593	HEAD LAMP (MANUAL) RH H7/H7/W5W
D0700169	81251016449, 81251016427, 81251016457	HEAD LAMP (MANUAL) LH H7/H7/W5W
DE0.0149	81253206092, 81253206112	FOG LAMP (YELLOW), RH H4 P21W
DE0.0148	81253206091, 81253206111	FOG LAMP (YELLOW), LH H4 P21W
DM2.0109	81253206114	FOG LAMP (CLEAR), RH H4/PY21W
DM2.0110	81253206113, 81253206107	FOG LAMP (CLEAR), L H H4/PY21W
DE0.0144	81252256523, 1357076, 1625986	TAIL LAMP RH P21W/P21W/P21W/P21W/R5W/R5W/R5W/R5W/R10W
DE0.0143	81252256524	TAIL LAMP L P21W/P21W/P21W/P21W/R5W/R5W/R5W/R5W/R10W
D0500126	81253206115, 81253206117, 81253206094	SIDE LAMP, YELLOW (R=L) AMBAR
DM2.0241	81253206118, 81253206106	SIDE LAMP, CLEAR (R=L) PY21W
D0700165	81252606101, 81252606096, 81252606097	SIDE LAMP, (R=L) LED

DIESSA REF.	O.E.M. REF.	DESCRIPTION
DC0.0619	81637306481,81637306432,81637306497	MAIN MIRROR RH CLASS II ELECTRIC HEATED R1200 LHD
DC0.0618	81637306480,81637306430,81637306482	MAIN MIRROR LH CLASS II ELECTRIC HEATED R1200 LHD
D0600573	81637306513,81637306410	WIDE ANGLE MIRROR RH CLASS IV ELECTRIC. HEATED R300 LHD
D0600572	81637306512,81637306409	WIDE ANGLE MIRROR LH CLASS IV ELECTRIC. HEATED R300 LHD
DC0.0621	81637336049	MIRROR GLASS CLASS II RH=LH HEATED R1200 LHD
DM2.0288	81637336057	MIRROR GLASS CLASS IV WIDE ANGLE RH=LH HEATED R300 LHD
DC0.0770	81615100490	CENTRAL STEP PANEL (R=L)
DC0.0840	81626100033	LH DOOR EXTENSION
DC0.0841	81626100032	RH DOOR EXTENSION
DC0.0769	81615100366	REAR PROLONGATION RH
DC0.0773	81615100554	REAR PROLONGATION LH
DM2.0114	81252256545,81252256551	TAIL LAMP RH (W/SOCKET) P21W/P21W/P21W/PY21W/R10W/R5W/R5W
DM2.0113	81252256544,81252256550	TAIL LAMP LH (W/SOCKET) P21W/P21W/P21W/PY21W/R10W/R5W/R5W
DE0.0146	81253206089	LIGHT PILOT WITHOUT ANTI-FOG HEADLIGHT LH
DE0.0147	81253206090	LIGHT PILOT WITHOUT ANTI-FOG HEADLIGHT RH
DE0.0142	81251100081	HEADLIGHT GLASS RH
DE0.0140	81251100080	HEADLIGHT GLASS LH
DM0.2077	81637320057	BACK COVER MIRROR LH
DM0.2359	81637320056	BACK COVER MIRROR RH
D0500386	81637320055	BACK COVER MIRROR II RH
D0500387	81637320054	BACK COVER MIRROR II LH
DM2.0071	81637310261	BACK COVER MIRROR LH
DM0.2401	81637310260	BACK COVER MIRROR RH





The parts referenced in this catalog are not original, but are perfectly adaptable to the models to which they are intended.  
The use of the manufacturers' marks and the original references is done exclusively for the purpose of indicating the model to which each piece is destined.



D0500627



D0600363



D0600362



D0700026

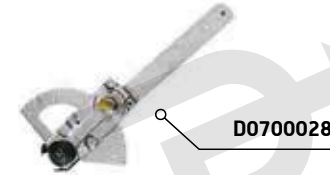

D0700028



DCO.0525  
DCO.0224



DE0.0162



DM0.2091



DE0.0195



DCO.0526



DM2.0125  
DM2.0279



DE0.0099



DCO.0601



DE0.0096



DM2.0282



DE0.0097



DCO.0470



DE0.0098

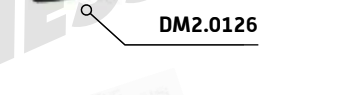

DM2.0126



DCO.0230



DE0.0074



DB0.0979



DM2.0082



DE0.0075



DM2.0277

The parts referenced in this catalog are not original, but are perfectly adaptable to the models to which they are intended. The use of the manufacturers' marks and the original references is done exclusively for the purpose of indicating the model to which each piece is destined.

DIESSA REF.	O.E.M. REF.	DESCRIPTION
DM0.1248	81611100043,81611100044	FRONT PANEL
DM0.1247	81611500109,81611505060	GRILLE
DM0.1171	81416104103,81416104113,81416104114	FR BUMPER
DM2.0041	81416105376	FR BUMPER (STEEL) MIDDLE
DB1.0672	81416100149,81416100191	COVER BUNPER UPPER
DM2.0043	81416105378,81416105454	CORNER BUMPER, (STEEL), RH
DM2.0042	81416105377,81416105453	CORNER BUMPER, (STEEL), LH
DC0.0601	81416130052,81416130071	SPOILER (H:350mm)
DC0.0470	81416130051,81416130073	SPOILER (H:250mm)
DB1.0674	81416100151	COVER BUMPER END LH
DB1.0675	81416100152	COVER BUMPER END RH
DM0.1394	81416130079,81416130057	AIR DEFLECTOR LH 250 mm
DM0.1172	81416130078,81416130056	AIR DEFLECTOR 250mm RH
DB0.0846	81416130081	AIR DEFLECTOR 350mm LH
DB0.0845	81416130080	AIR DEFLECTOR 350mm RH
DC0.0365	81615100226	FOOT STEP 250mm RH
DC0.0364	81615100225	FOOT STEP 250mm LH
DC0.0533	81615100229	FOOT STEP 350mm LH
DC0.0534	81615100230	FOOT STEP 350mm RH
DC0.0369	81615100268,81615100216	FOOTSTEP, UPPER GRILLE RH
DC0.0368	81615100267,81615100217	FOOTSTEP, UPPER GRILLE LH
DC0.0535	81615105181,81615105152	FOOTSTEP, LOWER GRILLE RH=LH
DC0.0362	81612105363	MUDGUARD CAB. 2400mm LH
DC0.0363	81612105364	MUDGUARD CAB. 2400mm RH
DM0.2091	83637010504	SUN VISOR BROWN
D0500627	81971006098	OUTSIDE HANDLE W/KEY SET, RH=LH
D0600362	81626410099	INSIDE HANDLE, FRONT RH
D0600363	81626410100	INSIDE HANDLE, FRONT LH
D0700026	81626406057	WINDOW REGULATOR MANUAL LH
D0700028	81626406058	WINDOW REGULATOR MANUAL RH
DE0.0162	81251016292	HEAD LAMP RH MANUAL H7/H7/W5W
DE0.0195	81251016291	HEAD LAMP LH MANUAL H7/H7/W5W

DIESSA REF.	O.E.M. REF.	DESCRIPTION
DE0.0097	81251016328,81251016338	FOG LAMP RH H3 H3
DE0.0098	81251016329,81251016329	FOG LAMP LH H3 H3
DE0.0074	81252286034,81252286027,81252286029	TAIL LAMP LH W/NUMBER PLATE P21W/P21W/P21W/P21W/R5W/R5W/R5W
DE0.0075	81252286033,81252286028,81252286030	TAIL LAMP RH W(O NUMBER PLATE P21W/P21W/P21W/P21W/R5W/R5W/R5W
DC0.0525	81637306317	MAIN MIRROR LH CLASS II ELECTRIC HEATED R1200 LHD
DC0.0526	81637306316,81637306367	MAIN MIRROR RH CLASS II ELECTRIC HEATED R1200 LHD
DM2.0126	81637330095,81637330067,81637330075	MIRROR GLASS CLASS II RH=LH HEATED R1200 LHD
DM2.0125	82637306023,82637306024	WIDE ANGLE MIRROR RH=LH CLASS IV MANUAL. HEATED R300 LHD
DM2.0279	82637306025,82637306026	WIDE ANGLE MIRROR RH=LH CLASS IV ELECTRIC. HEATED R300 LHD
DM2.0277	81637330098,81637330068,81637330097	MIRROR GLASS CLASS IV WIDE ANGLE RH=LH HEATED R300 LHD
DC0.0230	82637306033	MIRROR ROOF CLASS V RH MANUAL HEATED R300 LHD
DC0.0366	81615100224	FOOTSTEP, CENTRAL RH
DC0.0367	81615100223	FOOTSTEP, CENTRAL LH
DE0.0099	81251016289	MAIN HEADLIGHT WITH FLASHING PILOT LH
DE0.0096	81251016290	MAIN HEADLIGHT WITH FLASHING PILOT RH
DC0.0224	81637306305	MAIN MIRROR CLASS II L
DM2.0282	81637330100	CURB GLASS MIRROR
DB0.0979	85637100009	MIRROR COVER LH
DM2.0082	85637100010	MIRROR COVER RH







D060047



D060048



D060045



D060046

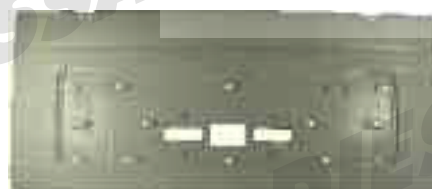

D0500196



DM2.0187



DC0.0845



DM2.0188



DM2.0111



DC0.1581



DC0.0809



DM2.0189



DM0.2140



DM2.0186



DM2.0186



DM2.0190

The parts referenced in this catalog are not original, but are perfectly adaptable to the models to which they are intended. The use of the manufacturers' marks and the original references is done exclusively for the purpose of indicating the model to which each piece is destined.



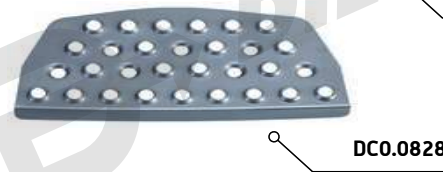
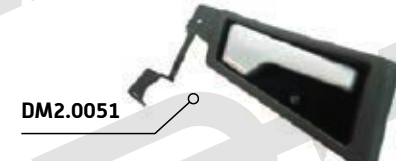

The parts referenced in this catalog are not original, but are perfectly adaptable to the models to which they are intended.  
The use of the manufacturers' marks and the original references is done exclusively for the purpose of indicating the model to which each piece is destined.

TGA 12/06->  
TGL 12/06 -11/14  
TGM 12/06 - 11/14

TGL, TGM (TGA) 06/2005->  
L 2000, M 2000 06/2005->



The parts referenced in this catalog are not original, but are perfectly adaptable to the models to which they are intended. The use of the manufacturers' marks and the original references is done exclusively for the purpose of indicating the model to which each piece is destined.

DIESSA REF.	O.E.M. REF.	DESCRIPTION
D0500196	81611100063,81611100054	FR PANEL
DC0.0845	81611505068,81611506049,81611505068	GRILLE
D0600447	81624100048	CORNER VANE, RH -->2006
D0600448	81624100049	CORNER VANE, LH -->2006
D0600445	81624100046	INNER CORNER VANE, RH -->2006
D0600446	81624100047	INNER CORNER VANE, LH -->2006
DC0.1581	81416100352	FR BUMPER
DM2.0186	81416100359	BUMPER
DM2.0187	81416100334	SIDE BUMPER COVER, RH
DM2.0188	81416100333,81416100343	SIDE BUMPER COVER, LH
DM2.0189	81416100344,81416100374	SIDE BUMPER COVER, RH
DM2.0190	81416100345,81416100373	SIDE BUMPER COVER, LH
DC0.0809	81416102900	STEP PLATE, BUMPER
DM2.0111	81416850059	BUMPER COVER (OVAL)
DM0.2140	81416850029	BUMEPK COVER (ROUND)
DM0.1818	81637010060,81637010047	SUN VISOR 2000mm
DM2.0056	81615100274	FOOTSTEP MUDGUARD, RH
DM2.0055	81615100275	FOOTSTEP MUDGUARD, LH
DM2.0156	81615100820,81615100942	FOOTSTEP MUDGUARD, RH
DM2.0157	81615100821,81615100941,816151000821	FOOTSTEP MUDGUARD, LH
DM2.0191	81615100562,81615100810	FOOTSTEP MUDGUARD, RH
DM2.0192	81615100563,81615100811	FOOTSTEP MUDGUARD, LH
DC2.2237	81615100570,81615100862,81615100864	FOOTSTEP, RH
DC2.2238	81615100861,81615100863,81615100573	FOOTSTEP, LH
DC0.0828	81615105187	LOWER STEP PANEL (R=L)
DC0.0901	81615110001,81615110000	STEP PANEL (R=L)
DM2.0184	81626416080	OUTSIDE HANDLE W/KEY SET, FRONT RH
DM0.2461	81626416081	OUTSIDE HANDLE W/KEY SET, FRONT LH
DM2.0185	81626416068	INSIDE HANDLE, FRONT RH
DM2.0051	81626416067	INSIDE HANDLE, FRONT LH
DM2.0114	81252256545,81252256551	TAIL LAMP RH (W/SOCKET) P21W/P21W/P21W/PY21W/R10W/R5W/R5W

DIESSA REF.	O.E.M. REF.	DESCRIPTION
DM2.0113	81252256544,81252256550	TAIL LAMP LH (W/SOCKET) P21W/P21W/P21W/PY21W/R10W/R5W/R5W
DM2.0241	81253206116,81253206118,81253206106	SIDE LAMP, CLEAR (R=L) PY21W
D0700165	81252606101,81252606096,81252606097	SIDE LAMP, (R=L) LED
DE0.0141	81251016450,81251016579,81251016352,81251016422,81251016430	HEAD LAMP (W/MOTOR) RH H7/H7/W5W
DE0.0139	81251006451,81251016580,81251016351,81251016421	HEAD LAMP (W/MOTOR) LH H7/H7/W5W
D0700168	81251016448,81251016428,81251016593	HEAD LAMP (MANUAL) RH H7/H7/W5W
D0700169	81251016449,81251016427,81251016457	HEAD LAMP (MANUAL) LH H7/H7/W5W
DE0.0149	81253206092,81253206112	FOG LAMP (YELLOW), RH H4 P21W
DE0.0148	81253206091,81253206111	FOG LAMP (YELLOW), LH H4 P21W
DM2.0109	81253206114	FOG LAMP (CLEAR), RH H4/PY21W
DM2.0110	81253206113,81253206107	FOG LAMP (CLEAR), L H H4/PY21W
DE0.0146	81253206089	LIGHT PILOT WITHOUT ANTI-FOG HEADLIGHT LH
DE0.0147	81253206090	LIGHT PILOT WITHOUT ANTI-FOG HEADLIGHT RH

TGA 12/06 -> TGL 12/06 -11/14 TGM 12/06 - 11/14

DC0.0618	81637306480,81637306430,81637306482	MAIN MIRROR LH CLASS II ELECTRIC HEATED R1200 LHD
D0600573	81637306513,81637306410	WIDE ANGLE MIRROR RH CLASS IV ELECTRIC. HEATED R300 LHD
D0600572	81637306512,81637306409	WIDE ANGLE MIRROR LH CLASS IV ELECTRIC. HEATED R300 LHD
DM2.0218	81637316560	MIRROR GLASS CLASS II RH=LH HEATED R1200 LHD
DM2.0217	81637316557	MIRROR GLASS CLASS IV WIDE ANGLE RH=LH HEATED R300 LHD
DC0.0619	81637306483,81637306432	MAIN MIRROR RH CLASS II ELECTRIC HEATED R1200 LHD
DM2.0287	81637306511	WIDE ANGLE MIRROR RH CLASS IV MANUAL.HEATED R300 LHD
DM2.0286	81637306510	WIDE ANGLE MIRROR LH CLASS IV MANUAL.HEATED R300 LHD
DC0.0621	81637336049	MIRROR GLASS CLASS II RH=LH HEATED R1200 LHD
DM2.0288	81637336057	MIRROR GLASS CLASS IV WIDE ANGLE RH=LH HEATED R300 LHD
DM0.2400	81637306733,81637306522	MIRROR ROOF CLASS V RH MANUAL R300 LHD

DIESSA REF.	O.E.M. REF.	DESCRIPTION
D0600577	81637306734, 81637306574, 81637306523	MIRROR ROOF CLASS V RH ELECTRIC HEATED R300 LHD

TGL, TGM (TGA) 06/2005 -> L 2000, M 2000 06/2005->

DM2.0294	85637306035	MAIN MIRROR LH CLASS II ELECTRIC HEATED R1200 LHD
DM2.0295	85637306036	MAIN MIRROR RH CLASS II ELECTRIC HEATED R1200 LHD
DM2.0296	81637330103	MIRROR GLASS CLASS II RH=LH HEATED R1200 LHD
DM2.0298	85637306039	WIDE ANGLE MIRROR RH=LH CLASS IV MANUAL HEATED R300 LHD
DM2.0299	81637330106	MIRROR GLASS CLASS IV WIDE ANGLE RH=LH HEATED R300 LHD
DC2.2351	81637306660	FRONT MIRROR CLASS VI RH MANUAL R300 LHD







DM2.0311



DM2.0312



DM2.0313



DM0.2142



DM2.0337



DM2.0171



DM2.0314



DM2.0315



DC2.3156



DM2.0310



DM2.0396



DM2.0316



DM2.0317



DM2.0079



DM2.0200



DM2.0321



DM2.0318

The parts referenced in this catalog are not original, but are perfectly adaptable to the models to which they are intended. The use of the manufacturers' marks and the original references is done exclusively for the purpose of indicating the model to which each piece is destined.



D0600453



D0600452



DC2.3314

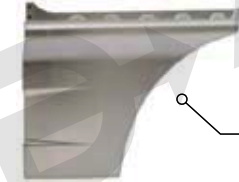

DM2.0167  
DC0.0840



DM0.2535



DM2.0323



D0700144



DM2.0324



DM0.2534



DM0.2533



D0500052



DM0.2537



D0500053



DM0.2532



D0500050

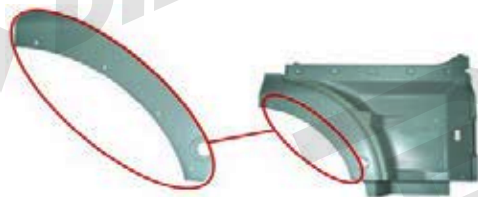

DM2.0360



DM2.0322



DM2.0320



DM2.0319

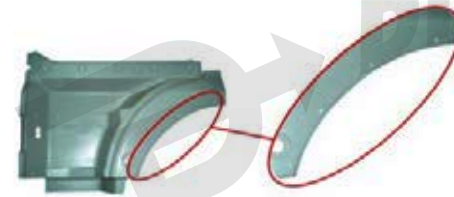

DM2.0403



D0500051

The parts referenced in this catalog are not original, but are perfectly adaptable to the models to which they are intended.  
The use of the manufacturers' marks and the original references is done exclusively for the purpose of indicating the model to which each piece is destined.



DM2.0358CZ



DM2.0357CZ



DC0.0922



DC0.0923



DC0.0829



D0600462



DC2.2979



DM0.2135



DM2.0061



DC2.2239

D0600463



DM2.0330



DC0.0901



D0700178



DM2.0331



DM2.0356



DM2.0407



DC0.0770



DC0.0828



DM2.0065



D0500401

The parts referenced in this catalog are not original, but are perfectly adaptable to the models to which they are intended. The use of the manufacturers' marks and the original references is done exclusively for the purpose of indicating the model to which each piece is destined.



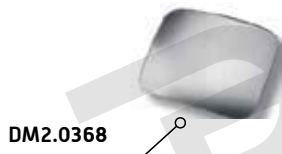
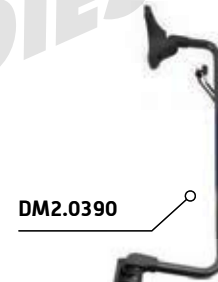

The parts referenced in this catalog are not original, but are perfectly adaptable to the models to which they are intended. The use of the manufacturers' marks and the original references is done exclusively for the purpose of indicating the model to which each piece is destined.

DIESSA REF.	O.E.M. REF.	DESCRIPTION
DM2.0337	81611106041,81611106076,81611106091	FR. PANEL
DM2.0310	81416100402	BUMPER
DM0.2142	81416140026	SIDE BUMPER, RH
DM2.0171	81416140025,81416140029	SIDE BUMPER, LH
DM2.0079	81416100364	BUMPER (WHITE)
DM2.0200	81416100363	BUMPER (GRAY)
DC2.3156	81416105610,81416105612	STEEL SIDE BUMPER, RH
DM2.0396	81416105609,81416105611	STEEL SIDE BUMPER, LH
DM2.0311	81416146004	SUPPORT, BUMPER, RH
DM2.0312	81416146003	SUPPORT, BUMPER, LH
DM2.0313	81416850072	UPPER COVER, BUMPER R
DM2.0314	81416850071	UPPER COVER, BUMPER L
DM2.0315	81416850114	LOWER COVER, BUMPER, RH
DM2.0316	81416850065	LOWER COVER, BUMPER, LH
DM2.0317	81416100370,814161003704,81416100372	SIDE BUMPER CAP, RH
DM2.0318	814161003695,81416100369,81416100371	SIDE BUMPER CAP, LH
DM2.0321	81416144000	CHROMED GRILLE MOLDING ON FRONT BUMPER
D0700144	81637010046,81637010031	SUN VISOR HIGH ROOF 2170mm
DM0.2537	81637010057	SUN VISOR 2210 mm
DM2.0322	81416142117,81416142117	UPPER STEP PLATE, BUMPER
DM2.0320	81416142183,81416142116	LOWER STEP PLATE, BUMPER (R=L)
DM2.0319	81416140041	STEP PLATE
DM2.0323	81416850096,81416850096	BUMPER COVER, RH
DM2.0324	81416850097,81416850097	BUMPER COVER, LH
D0600453	81626100018	DOOR EXTENTION (DARK-GRAY), RH (XXL)
D0600452	81626100019	DOOR EXTENTION (DARK-GRAY), LH (XXL)
DC2.3314	81626100024,81626100040	DOOR EXTENTION (WHITE), RH (XXL)
DM2.0167	81626100021	DOOR EXTENTION (WHITE), LH (XXL)
DM0.2535	81611100068	CORNER PANEL, RH
DM0.2534	81611100067	CORNER PANEL, LH
DM0.2533	81611106048	INNER CORNER VANE, RH

DIESSA REF.	O.E.M. REF.	DESCRIPTION
DM0.2532	81611106049,81611106033	INNER CORNER VANE, LH
D0500050	81615100826,81615100706,81615100402	FENDER (WHITE), RH
D0500051	81615100827,81615100705	FENDER (WHITE), LH
D0500052	81615100824,81615100914	FEMDER, RH
D0500053	81615100825,81615100399,81615100703,81615100913	FENDER, LH
DM2.0360	81615100623,81615100710,81615100830	FENDER RH
DM2.0403	81615100831	FENDER LH
DM2.0358CZ	81615100802	FOOT STEP (WHITE), RH
DM2.0357CZ	81615100801,81615100373,81615100803	FOOT STEP (WHITE), LH
DC0.0829	81615100536,81615100443,81615100468	COVER, STEPWALL
DC2.2239	81664400187	RE MUDGUARD COVER (RH=LH)
D0600462	81664100308,81664100204,81664100312	MUDGUARD SIDE PANEL (WHITE), RH
D0600463	81664100309,81664100205,81664100313	MUDGUARD SIDE PANEL (WHITE), LH
DM2.0330	81664100306	MUDGUARD SIDE PANEL (GREY), RH
DM2.0331	81664100307	MUDGUARD SIDE PANEL (GREY), LH
DM2.0061	81664106608	FR. RE MUDGUARD
D0700178	81664106606	TOP MUDGUARD W/O STRIPE
DM2.0065	81664106612	TOP MUDGUARD W/O STRAPE
DM2.0066	81664106607	TOP MUDGUARD W/O STRAPE
DM2.0356	81664400192	RUBBER STRIPE
DC0.0828	81615105187	LOWER STEP PANEL (R=L)
DC0.0901	81615110001,81615110000	STEP PANEL (R=L)
DC0.0770	81615100490,81615100271	LOWER STEP PANEL
DM2.0407	81418606110,81418606115	BATTERY COVER
D0500401	81418600144	BATTERY COVWR
DM2.0184	81626416080	OUTSIDE HANDLE W/KEY SET, FRONT RH
DM0.2461	81626416081	OUTSIDE HANDLE W/KEY SET, FRONT LH
DM2.0185	81626416068	INSIDE HANDLE, FRONT RH
DM2.0051	81626416067	INSIDE HANDLE, FRONT LH

DIESSA REF.	O.E.M. REF.	DESCRIPTION
DM2.0205	81251016498	HEAD LAMP (ELEC.) RH H7/H7/PY21W/LED
DM2.0096	81251016499	HEAD LAMP (ELEC.) LH H7/H7/PY21W/LED
DM2.0224	81251016496	HEAD LAMP RH MANUAL W/O DAY TIME H7/H7/PY21W/LED
DM2.0223	81251016497	HEAD LAMP LH MANUAL W/O DAY TIME H7/H7/PY21W/LED
DM2.0170	81251016522	FOG LAMP RH H4/PY21W
DM2.0169	81251016521	FOG LAMP LH H4/PY21W
DM2.0114	81252256545,81252256551	TAIL LAMP RH (W/SOCKET) P21W/P21W/P21W/PY21W/R10W/R5W/R5W
DM2.0113	81252256544,81252256550	TAIL LAMP LH (W/SOCKET) P21W/P21W/P21W/PY21W/R10W/R5W/R5W
DM2.0241	81253206116,81253206118,81253206106	SIDE LAMP, CLEAR (R=L) PY21W
D0700165	81252606101,81252606096,81252606097	SIDE LAMP, (R=L) LED
DM2.0391	81637306550	COMPLETE MIRROR RH MAIN MIRROR CLASS II ELECTRIC WIDE ANGLE MIRROR CLASS IV ELECTRIC. HEATED SHORT ARM R1200+R300 LHD
DM2.0388	81637306549	COMPLETE MIRROR RH MAIN MIRROR CLASS II ELECTRIC WIDE ANGLE MIRROR CLASS IV ELECTRIC. HEATED SHORT ARM R1200+R300 LHD
DM2.0393	81637306533	COMPLETE MIRROR LH MAIN MIRROR CLASS II ELECTRIC WIDE ANGLE MIRROR CLASS IV MANUAL. HEATED SHORT ARM R1200+R300 LHD
DM2.0387	81637306534	COMPLETE MIRROR RH MAIN MIRROR CLASS II ELECTRIC WIDE ANGLE MIRROR CLASS IV MANUAL. HEATED SHORT ARM R1200+R300 LHD
DM2.0369	81637336071	MIRROR GLASS CLASS II RH=LH HEATED R1200 LHD
DM2.0368	81637336072	MIRROR GLASS CLASS IV WIDE ANGLE RH HEATED R300 LHD
DM2.0377	81637336073	MIRROR GLASS CLASS IV WIDE ANGLE LH HEATED R300 LHD
DC2.2409	81637306578,81637306735,81637306654	MIRROR ROOF CLASS V RH ELECTRIC HEATED R300 LHD
DC0.0840	81626100033	DOOR EXTENTION (WHITE), LH (XXL)
DC2.2979	81664106599	FR. RE MUDGUARD
DM0.2135	81664106625,81664106605	RE, RE MUDGUARD
DC0.0923	81615100797,81615100311,81615100747	FOOT STEP (BLACK), LH
DC0.0922	81615100372, 81615100748	FOOT STEP (BLACK), RH
DM2.0378	81637310356	BACK COVER MIRROR, LH-RH
DM2.0390	81637316641	ARM MIRROR CLASS II-IV RH
DM2.0389	81637316640	ARM MIRROR CLASS II-IV LH
DM2.0372	81637306560	COMPLETE MIRROR CLASS II-IV LH
DC0.2126	81637306561	COMPLETE MIRROR CLASS II-IV RH ELECTRIC



The parts referenced in this catalog are not original, but are perfectly adaptable to the models to which they are intended.  
 The use of the manufacturers' marks and the original references is done exclusively for the purpose of indicating the model to which each piece is destined.





DM2.0326



DM2.0327



DC2.3159



DC2.2809

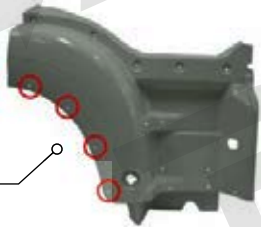

DC2.3160



DM0.1818



DC2.3161



DC0.0768



DM2.0121



DC0.0829



DC0.0830



DC0.0772



D0500398



DC0.0827



DC0.0830



D0500399

The parts referenced in this catalog are not original, but are perfectly adaptable to the models to which they are intended. The use of the manufacturers' marks and the original references is done exclusively for the purpose of indicating the model to which each piece is destined.



DC0.0828



DC0.0901



DC0.0770



DM2.0308



DC0.0804



DC2.2979



DM0.2135



D0700178



DM2.0061



DC0.0805



D0500401



DM2.0356



DM2.0307

The parts referenced in this catalog are not original, but are perfectly adaptable to the models to which they are intended. The use of the manufacturers' marks and the original references is done exclusively for the purpose of indicating the model to which each piece is destined.

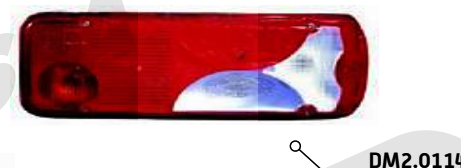
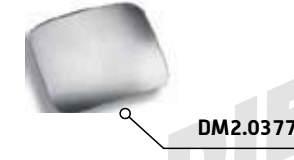
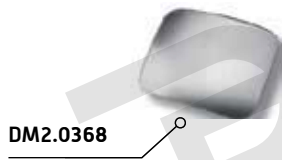

The parts referenced in this catalog are not original, but are perfectly adaptable to the models to which they are intended. The use of the manufacturers' marks and the original references is done exclusively for the purpose of indicating the model to which each piece is destined.



DIESSA REF.	O.E.M. REF.	DESCRIPTION
DC2.3158	81416100397	BUMPER
DM2.0119	81416140024	SIDE BUMPER, R
DM2.0118	81416140023	SIDE BUMPER, LH
DM2.0341	81416100362	BUMPER PRIMED
DM2.0080	81416100361,81416100408	BUMPER (GREY)
DM0.1818	81637010060,81637010047	SUN VISOR 2000mm
DM2.0322	81416142184,/81416142117	UPPER STEP PLATE, BUMPER
DM2.0320	81416142183,81416142116	LOWER STEP PLATE, BUMPER (R=L)
DM0.2140	81416850029,81416850057	BUMEP COVER (ROUND)
DC2.2804	81416100368	SIDE BUMPER CAP, R
DC2.2977	81416100367	SIDE BUMPER CAP, LH
DC2.3637	81416850094	COVER RH, BUMPER
DC2.3636	81416850095	COVER LH, BUMPER
DC0.0841	81626100032	RH DOOR EXTENSION
DC0.0840	81626100033	LH DOOR EXTENSION
DM0.2535	81611100068	CORNER PANEL, R
DM0.2534	81611100067	CORNER PANEL, LH
DM0.2533	81611106048	INNER CORNER VANE, RH
DM0.2532	81611106049	INNER CORNER VANE, LH
DM2.0326	81615100854, 81615100936, 81615100482	FENDER RH (WIDE)
DM2.0327	81615100853, 81615100583, 81615100585, 81615100587	FENDER LH (WIDE)
DC2.3159	81615100758,81615100470	FRONT MUDGUARD RH
DC2.2809	81615100757,81615100869	FRONT MUDGUARD LH
DC2.3160	81615100762,81615100598	FRONT MUDGUARD W/HOLE RH
DC2.3161	81615100761,81615100597	FRONT MUDGUARD W/HOLE LH
DC0.0768	81615100474,81615100358	FRONT MUDGUARD RH
DC0.0772	81615100475,81615100845	FRONT MUDGUARD LH
DM2.0121	81615100738	STEP PANEL( DARK-GREY), RH
D0500398	81615100380,81615100736	FOOTBOARD (BLK), RH (LX)
D0500399	81615100351,81615100735	FOOTBOARD (BLK), LH (LX)
DC0.0827	81615100382, 81615100354	FOOTBOARD (WHITE), RH (LX)

DIESSA REF.	O.E.M. REF.	DESCRIPTION
DC0.0830	81615100355, 81615100679, 81615100739	FOOTBOARD (WHITE), LH
DC0.0829	81615100536,81615100443, 81615100468	COVER, STEPWALL
D0600462	81664100308,81664100204, 81664100312	MUDGUARD SIDE PANEL (WHITE), RH
D0600463	81664100309,81664100205, 81664100313	MUDGUARD SIDE PANEL (WHITE), LH
DM2.0330	81664100306	MUDGUARD SIDE PANEL (GREY), RH
DM2.0331	81664100307	MUDGUARD SIDE PANEL (GREY), LH
DM2.0061	81664106608	FR. RE MUDGUARD
DM0.2135	81664106605	RE, RE MUDGUARD
D0700178	81664106606	TOP MUDGUARD W/O STRIPE
DM2.0065	81664106612	TOP MUDGUARD W/O STRAPE
DM2.0066	81664106607	TOP MUDGUARD W/O STRAPE
DM2.0308	81612100676	FR MUDGUARD (SMALL WHEEL) GREY, RH
DM2.0307	81612100675,81664100181, 81664100361	FR MUDGUARD (SMALL WHEEL) GREY, LH
DM2.0356	81664400192	RUBBER STRIPE
D0500401	81418600144	BATTERY COVWR
DC0.0828	81615105187	LOWER STEP PANEL (R=L)
DC0.0901	81615110001,81615110000	STEP PANEL (R=L)
DC0.0770	81615100490,81615100271	LOWER STEP PANEL
DM2.0184	81626416080	OUTSIDE HANDLE W/KEY SET, FRONT RH
DM0.2461	81626416081	OUTSIDE HANDLE W/KEY SET, FRONT LH
DM2.0185	81626416068	INSIDE HANDLE, FRONT RH
DM2.0051	81626416067	INSIDE HANDLE, FRONT LH
DM2.0205	81251016498	HEAD LAMP (ELEC.) RH H7/H7/PY21W/LED
DM2.0096	81251016499	HEAD LAMP (ELEC.) LH H7/H7/PY21W/LED
DM2.0224	81251016496	HEAD LAMP RH MANUAL W/O DAY TIME H7/H7/PY21W/LED
DM2.0223	81251016497	HEAD LAMP LH MANUAL W/O DAY TIME H7/H7/PY21W/LED
DM2.0170	81251016522	FOG LAMP RH H4/PY21W
DM2.0169	81251016521	FOG LAMP LH H4/PY21W
DM2.0114	81252256545, 81252256551	TAIL LAMP RH (W/SOCKET) P21W/P21W/P21W/PV21W/R10W/R5W/R5W
DM2.0113	81252256544,81252256550	TAIL LAMP LH (W/SOCKET) P21W/P21W/P21W/PV21W/R10W/R5W/R5W



DIESSA REF.	O.E.M. REF.	DESCRIPTION
DM2.0241	81253206116,81253206118 81253206106	SIDE LAMP, CLEAR (R=L) PY21W
DM2.0391	81637306550	COMPLETE MIRROR RH MAIN MIRROR CLASS II ELECTRIC WIDE ANGLE MIRROR CLASS IV ELECTRIC. HEATED SHORT ARM R1200+R300 LHD
DM2.0388	81637306549	COMPLETE MIRROR RH MAIN MIRROR CLASS II ELECTRIC WIDE ANGLE MIRROR CLASS IV ELECTRIC. HEATED SHORT ARM R1200+R300 LHD
DM2.0393	81637306533	COMPLETE MIRROR LH MAIN MIRROR CLASS II ELECTRIC WIDE ANGLE MIRROR CLASS IV MANUAL. HEATED SHORT ARM R1200+R300 LHD
DM2.0387	81637306534	COMPLETE MIRROR RH MAIN MIRROR CLASS II ELECTRIC WIDE ANGLE MIRROR CLASS IV MANUAL. HEATED SHORT ARM R1200+R300 LHD
DM2.0369	81637336071	MIRROR GLASS CLASS II RH=LH HEATED R1200 LHD
DM2.0368	81637336072	MIRROR GLASS CLASS IV WIDE ANGLE RH HEATED R300 LHD
DM2.0377	81637336073	MIRROR GLASS CLASS IV WIDE ANGLE LH HEATED R300 LHD
DC2.2409	81637306578,81637306735, 81637306654	MIRROR ROOF CLASS V RH ELECTRIC HEATED R300 LHD
DC2.2299	81611506066	RADIATOR GRID
DM2.0319	81416140041	STEP PLATE
DC2.2979	81664106599	FR. RE MUDGUARD
DC0.0804	81612100684,81664100363, 81664100367	FR MUDGUARD (BIG WHEEL) GREY, RH
DC0.0805	81612100683, 81612100681	FR MUDGUARD (BIG WHEEL) GREY, LH
DM2.0378	81637310356	BACK COVER MIRROR, LH-RH
DM2.0390	81637316641	ARM MIRROR CLASS II-IV RH
DM2.0389	81637316640	ARM MIRROR CLASS II-IV LH
DM2.0372	81637306560	COMPLETE MIRROR CLASS II-IV LH
DC0.2126	81637306561	COMPLETE MIRROR CLASS II-IV RH ELECTRIC



DCO.0828



DCO.0901



DCO.0770

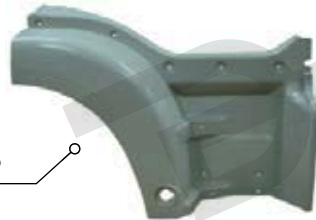

DM2.0326



DM0.1818



DM2.0327



DM2.0308



D0700144



DM0.2489



DM0.2492



DM0.2488



DM2.0307

The parts referenced in this catalog are not original, but are perfectly adaptable to the models to which they are intended. The use of the manufacturers' marks and the original references is done exclusively for the purpose of indicating the model to which each piece is destined.

DIESSA REF.	O.E.M. REF.	DESCRIPTION
DM0.2492	81416105451,81416105664, 81416105722	STEEL CENTRAL BUMPER (TGS)
DM0.1818	81637010060,81637010047	SUN VISOR 2000mm
D0700144	81637010046,81637010031	SUN VISOR HIGH ROOF 2170mm
DM0.2489	81416105598	STEEL SIDE BUMPER, RH
DM0.2488	81416105597	STEEL SIDE BUMPER, LH
DM2.0326	81615100854, 81615100936, 81615100482	FENDER RH (WIDE)
DM2.0327	81615100853,81615100583, 81615100585, 81615100587	FENDER LH (WIDE)
DM2.0308	81612100676	FR MUDGUARD (SMALL WHEEL) GREY, RH
DM2.0307	81612100675,81664100181, 81664100361	FR MUDGUARD (SMALL WHEEL) GREY, LH
DC0.0828	81615105187	LOWER STEP PANEL (R=L)
DC0.0901	81615110001,81615110000	STEP PANEL (R=L)
DC0.0770	81615100490,81615100271	LOWER STEP PANEL



DC2.3608



DC2.3607



DC2.3606



DC2.3605



DC2.3166



DC2.3163



DC2.3604



DC2.3451



DC2.3162



DC2.3167



DC2.3168



DC2.3170



DC2.3452



DC2.3165



DC2.3171



DC2.3169

The parts referenced in this catalog are not original, but are perfectly adaptable to the models to which they are intended. The use of the manufacturers' marks and the original references is done exclusively for the purpose of indicating the model to which each piece is destined.



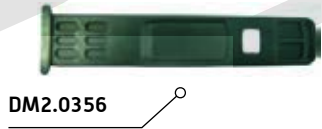
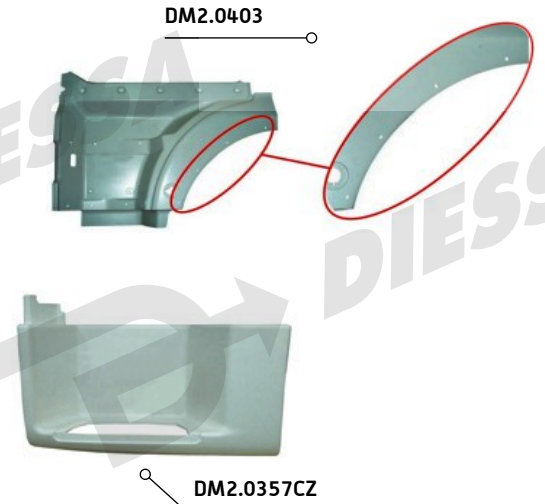
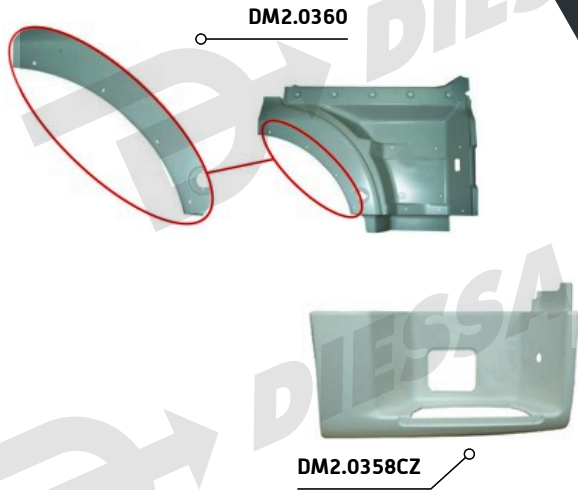

The parts referenced in this catalog are not original, but are perfectly adaptable to the models to which they are intended.  
The use of the manufacturers' marks and the original references is done exclusively for the purpose of indicating the model to which each piece is destined.



DCO.0828



DCO.0919



DCO.0901



DM2.0390

DM2.0389



DM2.0184



DM2.0368



DM2.0377



DM0.2461



DM2.0185

DM2.0372



DM2.0393  
DM2.0391



DCO.2126



DM2.0387  
DM2.0388



DC2.2409



DM2.0378



DM2.0369



DM2.0051

The parts referenced in this catalog are not original, but are perfectly adaptable to the models to which they are intended. The use of the manufacturers' marks and the original references is done exclusively for the purpose of indicating the model to which each piece is destined.

DIESSA REF.	O.E.M. REF.	DESCRIPTION
DC2.3604	81611106095	CENTRAL GRILLE
DC2.3451	81416106863,81416106758	FRONT MIDDLE BUMPER
DC2.3452	81416146009	STEP ON MIDDLE FRONT BUMPER
DC2.3165	81416140076	MIDDLE FRONT SPOILER
DC2.3607	81611100088	AIR DEFECTOR, RH
DC2.3608	81611100089	AIR DEFECTOR, LH
DC2.3605	81611100122	INNER CONER VANE, RH
DC2.3606	81611100123	INNER CONER VANE, LH
DC2.3162	81416106754	LOWER SIDE BUMPER, RH WHITE
DC2.3163	81416106755	LOWER SIDE BUMPER, LH WHITE
DC2.3170	81416106760	INNER HEADLAMP SUPPORT, RH
DC2.3171	81416106759	INNER HEADLAMP SUPPORT, LH
DC2.3168	81416106752	UPPER SIDE BUMPER RH
DC2.3169	81416106753	UPPER SIDE BUMPER LH
DC2.3166	81626004130	COMPLETE DOOR, RH
DC2.3167	81626004129	COMPLETE DOOR, LH
DM2.0358CZ	81615100752,81615100802, 81615100978	FOOT STEP (WHITE), RH
DM2.0357CZ	81615100333,81615100751, 81615100801	FOOT STEP (WHITE), LH
DC0.0829	81615100536,81615100443, 81615100468	COVER, STEPWALL
DC2.3012	81612100442	FRONT MUDGUARD REAR PART, RH
DC2.3011	81612100443	FRONT MUDGUARD REAR PART, LH
D0600464	81612100462	REAR MUDGUARD RH/LH
DM2.0061	81664106608	FR. RE MUDGUARD
D0700178	81664106606	TOP MUDGUARD W/O STRIPE
DM2.0065	81664106612	TOP MUDGUARD W/O STRAPE
DM2.0360	81615100623,81615100710, 81615100830	FENDER R
DM2.0403	81615100831	FENDER L
DM2.0356	81664400192	RUBBER STRIPE
DC0.0828	81615105187	LOWER STEP PANEL (R=L)
DC0.0901	81615110001,81615110000	STEP PANEL (R=L)
DC0.0919	81615100273	UPPER STEP PANEL (R=L)

DIESSA REF.	O.E.M. REF.	DESCRIPTION
DM2.0184	81626416080	OUTSIDE HANDLE W/KEY SET, FRONT RH
DM0.2461	81626416081	OUTSIDE HANDLE W/KEY SET, FRONT LH
DM2.0185	81626416068	INSIDE HANDLE, FRONT RH
DM2.0051	81626416067	INSIDE HANDLE, FRONT LH
DM2.0391	81637306550	COMPLETE MIRROR RH MAIN MIRROR CLASS II ELECTRIC WIDE ANGLE MIRROR CLASS IV ELECTRIC. HEATED SHORT ARM R1200+R300 LHD
DM2.0388	81637306549	COMPLETE MIRROR RH MAIN MIRROR CLASS II ELECTRIC WIDE ANGLE MIRROR CLASS IV ELECTRIC. HEATED SHORT ARM R1200+R300 LHD
DM2.0393	81637306533	COMPLETE MIRROR LH MAIN MIRROR CLASS II ELECTRIC WIDE ANGLE MIRROR CLASS IV MANUAL. HEATED SHORT ARM R1200+R300 LHD
DM2.0387	81637306534	COMPLETE MIRROR RH MAIN MIRROR CLASS II ELECTRIC WIDE ANGLE MIRROR CLASS IV MANUAL. HEATED SHORT ARM R1200+R300 LHD
DM2.0369	81637336071	MIRROR GLASS CLASS II RH=LH HEATED R1200 LHD
DM2.0368	81637336072	MIRROR GLASS CLASS IV WIDE ANGLE RH HEATED R300 LHD
DM2.0377	81637336073	MIRROR GLASS CLASS IV WIDE ANGLE LH HEATED R300 LHD
DC0.0923	81615100797,81615100751, 81615100311,81615100747	FOOT STEP (BLACK), LH
DC0.0922	81615100372,81615100748	FOOT STEP (BLACK), RH
DC2.2409	81637306578,81637306735, 81637306654	MIRROR ROOF CLASS V RH ELECTRIC HEATED R300 LHD
DC2.2979	81664106599	FR. RE MUDGUARD
DM0.2135	81664106625,81664106605	RE, RE MUDGUARD
DM2.0378	81637310356	BACK COVER MIRROR, LH-RH
DM2.0390	81637316641	ARM MIRROR CLASS II-IV RH
DM2.0389	81637316640	ARM MIRROR CLASS II-IV LH
DM2.0372	81637306560	COMPLETE MIRROR CLASS II-IV LH
DC0.2126	81637306561	COMPLETE MIRROR CLASS II-IV RH ELECTRIC



DC2.3608

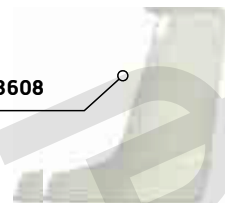

DC2.3607

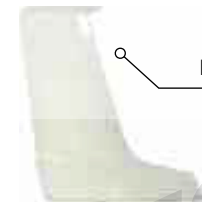

DC2.3606



DC2.3605



DC2.3159



DC2.3639



DC2.2809



DC2.3640



DC2.3172



DC2.3173



DC2.3174



DC2.3177



DC2.3175



DC2.3176



DC2.3178



The parts referenced in this catalog are not original, but are perfectly adaptable to the models to which they are intended. The use of the manufacturers' marks and the original references is done exclusively for the purpose of indicating the model to which each piece is destined.





DM2.0121



DC0.0830



D0500398



D0500399



DC0.0841



D0600464



DM2.0065



D0700178



DM2.0061



DC0.0840



DC2.2979



DM2.0356



DC0.0829

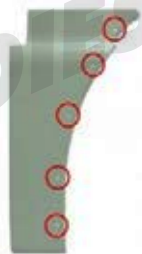

DC2.3012



DC2.3011



DM0.2135

The parts referenced in this catalog are not original, but are perfectly adaptable to the models to which they are intended.  
The use of the manufacturers' marks and the original references is done exclusively for the purpose of indicating the model to which each piece is destined.



DCO.0828



DCO.0770



DCO.0901

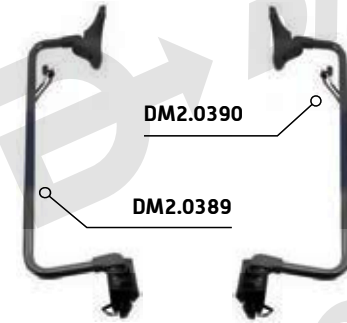

DM2.0390

DM2.0389



DM2.0184



DM2.0372



DM2.0368



DM2.0377



DM0.2461



DM2.0393  
DM2.0391



DM2.0387  
DM2.0388



DCO.2126



DM2.0185



DM2.0378



DM2.0369



DC2.2409



DM2.0051

The parts referenced in this catalog are not original, but are perfectly adaptable to the models to which they are intended. The use of the manufacturers' marks and the original references is done exclusively for the purpose of indicating the model to which each piece is destined.

DIESSA REF.	O.E.M. REF.	DESCRIPTION
DC2.3639	81611106096	CENTRAL GRILLE
DC2.3640	81611106097	GRILLE
DC2.3172	81416106769	MIDDLE FRONT BUMPER
DC2.3173	81416106766	RH LOWER SIDE BUMPER
DC2.3174	81416106765	LH LOWER SIDE BUMPER
DC2.3175	81416146010	STEP ON MIDDLE FRONT BUMPER
DC2.3176	81416140077	MIDDLE FRONT SPOILER
DC2.3177	81416106764	UPPER SIDE BUMPER, RH
DC2.3178	81416106763	UPPER SIDE BUMPER, LH
DC2.3607	81611100088	AIR DEFECTOR, RH
DC2.3608	81611100089	AIR DEFECTOR, LH
DC2.3605	81611100122	INNER CONER VANE, RH
DC2.3606	81611100123	INNER CONER VANE, LH
DC2.3159	81615100758,81615100870, 81615100470	FRONT MUDGUARD RH
DC2.2809	81615100757,81615100869, 81615100869	FRONT MUDGUARD LH
DM2.0121	81615100680,81615100738	STEP PANEL(DARK-GRAY), R
DC0.0830	81615100355, 81615100679, 81615100739	FOOTBOARD (WHITE), LH
D0500398	81615100380,81615100736	FOOTBOARD (BLK), R (LX)
D0500399	81615100351,81615100735	FOOTBOARD (BLK), LH (LX)
DC0.0841	81626100032	RH DOOR EXTENSION
DC0.0840	81626100033	LH DOOR EXTENSION
D0600464	81612100462	REAR MUDGUARD RH/LH
DM2.0061	81664106608	FR. RE MUDGUARD
D0700178	81664106606	TOP MUDGUARD W/O STRIPE
DM2.0065	81664106612	TOP MUDGUARD W/O STRAPE
DC2.3012	81612100442	FRONT MUDGUARD REAR PART, RH
DC2.3011	81612100443	FRONT MUDGUARD REAR PART, LH
DC0.0829	81615100536,81615100443, 81615100468	COVER, STEPWALL
DM2.0356	81664400192	RUBBER STRIPE
DC0.0828	81615105187	LOWER STEP PANEL (R=L)
DC0.0901	81615110001,81615110000	STEP PANEL (RH=LH)

DIESSA REF.	O.E.M. REF.	DESCRIPTION
DC0.0770	81615100490,81615100271	LOWER STEP PANEL
DM2.0184	81626416080	OUTSIDE HANDLE W/KEY SET, FRONT RH
DM0.2461	81626416081	OUTSIDE HANDLE W/KEY SET, FRONT LH
DM2.0185	81626416068	INSIDE HANDLE, FRONT RH
DM2.0051	81626416067	INSIDE HANDLE, FRONT LH
DM2.0391	81637306550	COMPLETE MIRROR RH MAIN MIRROR CLASS II ELECTRIC WIDE ANGLE MIRROR CLASS IV ELECTRIC. HEATED SHORT ARM R1200+R300 LHD
DM2.0388	81637306549	COMPLETE MIRROR RH MAIN MIRROR CLASS II ELECTRIC WIDE ANGLE MIRROR CLASS IV ELECTRIC. HEATED SHORT ARM R1200+R300 LHD
DM2.0393	81637306533	COMPLETE MIRROR LH MAIN MIRROR CLASS II ELECTRIC WIDE ANGLE MIRROR CLASS IV MANUAL. HEATED SHORT ARM R1200+R300 LHD
DM2.0387	81637306534	COMPLETE MIRROR RH MAIN MIRROR CLASS II ELECTRIC WIDE ANGLE MIRROR CLASS IV MANUAL. HEATED SHORT ARM R1200+R300 LHD
DM2.0369	81637336071	MIRROR GLASS CLASS II RH=LH HEATED R1200 LHD
DM2.0368	81637336072	MIRROR GLASS CLASS IV WIDE ANGLE RH HEATED R300 LHD
DM2.0377	81637336073	MIRROR GLASS CLASS IV WIDE ANGLE LH HEATED R300 LHD
DC2.2409	81637306578,81637306735, 81637306654	MIRROR ROOF CLASS V RH ELECTRIC HEATED R300 LHD
DM0.2135	81664106605	RE, RE MUDGUARD
DC2.2979	81664106599	FR. RE MUDGUARD
DM2.0378	81637310356	BACK COVER MIRROR, LH-RH
DM2.0390	81637316641	ARM MIRROR CLASS II-IV RH
DM2.0389	81637316640	ARM MIRROR CLASS II-IV LH
DM2.0372	81637306560	COMPLETE MIRROR CLASS II-IV LH
DC0.2126	81637306561	COMPLETE MIRROR CLASS II-IV RH ELECTRIC



DC2.3159



DC2.3160



DC2.2809



DC2.3161



DC0.0768



DC2.3581



DC2.3648



DC2.3582



DC0.0772



DC2.3647



DC2.3642



DC2.3177



DC2.3645



DC2.3178



DC2.3643

The parts referenced in this catalog are not original, but are perfectly adaptable to the models to which they are intended. The use of the manufacturers' marks and the original references is done exclusively for the purpose of indicating the model to which each piece is destined.





DM2.0121



DC0.0830



DC0.0841



D0500398



D0500399



DC0.0840



DC2.2979



D0600464



DC2.3644



DM2.0061



DM0.2135



DC2.3641



D0700178

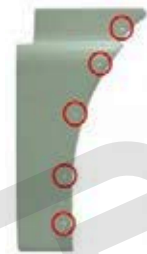

DC2.3012



DC2.3646



DM2.0065



DM2.0356



DC2.3649



DC2.3011



DC0.0829

The parts referenced in this catalog are not original, but are perfectly adaptable to the models to which they are intended. The use of the manufacturers' marks and the original references is done exclusively for the purpose of indicating the model to which each piece is destined.



DCO.0828



DCO.0770



DCO.0901

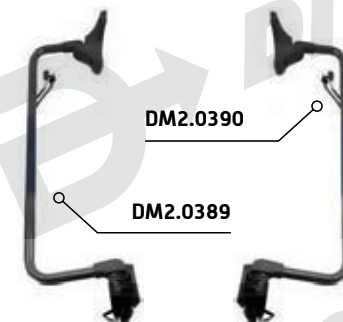

DM2.0390

DM2.0389



DM2.0184



DM2.0368



DM2.0377



DM0.2461



DM2.0372



DM2.0387  
DM2.0388



DCO.2126



DM2.0185



DM2.0378



DM2.0369

DM2.0393  
DM2.0391



DC2.2409



DM2.0051

The parts referenced in this catalog are not original, but are perfectly adaptable to the models to which they are intended. The use of the manufacturers' marks and the original references is done exclusively for the purpose of indicating the model to which each piece is destined.

DIESSA REF.	O.E.M. REF.	DESCRIPTION
DC2.3648	81611106104	CENTRAL GRILLE
DC2.3647	81611106101	GRILLE
DC2.3645	81416106684	CENTRAL BUMPER
DC2.3582	81416105732	SIDE BUMPER RH
DC2.3581	81416105731	SIDE BUMPER LH
DC2.3644	81416105746	BUMPER SUPPORT
DC2.3641	81416100463	STEP PLATE ON CENTRAL BUMPER
DC2.3646	81416106806	BUMPER EXTENSION
DC2.3649	81429400304	LICENSE PLATE HOLDER
DC2.3643	81416105728	HEAD LAMP SEAT RH
DC2.3642	81416105727	HEAD LAMP SEAT LH
DC2.3177	81416106764	UPPER SIDE BUMPER, RH
DC2.3178	81416106763	UPPER SIDE BUMPER, LH
DC2.3159	81615100758,81615100870, 81615100470	FRONT MUDGUARD RH
DC2.2809	81615100757,81615100869, 81615100869	FRONT MUDGUARD LH
DC2.3160	81615100762,81615100598	FRONT MUDGUARD W/HOLE RH
DC2.3161	81615100761,81615100597	FRONT MUDGUARD W/HOLE LH
DC0.0768	81615100474,81615100358	FRONT MUDGUARD RH
DC0.0772	81615100475,81615100845	FRONT MUDGUARD LH
DM2.0121	81615100680,81615100738	STEP PANEL [ DARK-GREY ], R
DC0.0830	81615100355, 81615100679, 81615100739	FOOTBOARD (WHITE), LH
D0500398	81615100380,81615100736	FOOTBOARD (BLK), R [LX]
D0500399	81615100351,81615100735	FOOTBOARD (BLK), LH [LX]
DC0.0841	81626100032	RH DOOR EXTENSION
DC0.0840	81626100033	LH DOOR EXTENSION
D0600464	81612100462	REAR MUDGUARD RH/LH
DM2.0061	81664106608	FR. RE MUDGUARD
D0700178	81664106606	TOP MUDGUARD W/O STRIPE
DM2.0065	81664106612	TOP MUDGUARD W/O STRAPE
DC2.3012	81612100442	FRONT MUDGUARD REAR PART, RH
DC2.3011	81612100443	FRONT MUDGUARD REAR PART, LH

DIESSA REF.	O.E.M. REF.	DESCRIPTION
DC0.0829	81615100536,81615100443 ,81615100468	COVER, STEPWALL
DM2.0356	81664400192	RUBBER STRIPE
DC0.0828	81615105187	LOWER STEP PANEL (R=L)
DC0.0901	81615110001,81615110000	STEP PANEL (RH=LH)
DC0.0770	81615100490,81615100271	LOWER STEP PANEL
DM2.0184	81626416080	OUTSIDE HANDLE W/KEY SET, FRONT RH
DM0.2461	81626416081	OUTSIDE HANDLE W/KEY SET, FRONT LH
DM2.0185	81626416068	INSIDE HANDLE, FRONT RH
DM2.0051	81626416067	INSIDE HANDLE, FRONT LH
DM2.0391	81637306550	COMPLETE MIRROR RH MAIN MIRROR CLASS II ELECTRIC WIDE ANGLE MIRROR CLASS IV ELECTRIC. HEATED SHORT ARM R1200+R300 LHD
DM2.0388	81637306549	COMPLETE MIRROR RH MAIN MIRROR CLASS II ELECTRIC WIDE ANGLE MIRROR CLASS IV ELECTRIC. HEATED SHORT ARM R1200+R300 LHD
DM2.0393	81637306533	COMPLETE MIRROR LH MAIN MIRROR CLASS II ELECTRIC WIDE ANGLE MIRROR CLASS IV MANUAL. HEATED SHORT ARM R1200+R300 LHD
DM2.0387	81637306534	COMPLETE MIRROR RH MAIN MIRROR CLASS II ELECTRIC WIDE ANGLE MIRROR CLASS IV MANUAL. HEATED SHORT ARM R1200+R300 LHD
DM2.0369	81637336071	MIRROR GLASS CLASS II RH=LH HEATED R1200 LHD
DM2.0368	81637336072	MIRROR GLASS CLASS IV WIDE ANGLE RH HEATED R300 LHD
DM2.0377	81637336073	MIRROR GLASS CLASS IV WIDE ANGLE LH HEATED R300 LHD
DC2.2409	81637306578,81637306735, 81637306654	MIRROR ROOF CLASS V RH ELECTRIC HEATED R300 LHD
DM0.2135	81664106625,81664106605	RE, RE MUDGUARD
DC2.2979	81664106599	FR. RE MUDGUARD
DM2.0378	81637310356	BACK COVER MIRROR, LH-RH
DM2.0390	81637316641	ARM MIRROR CLASS II-IV RH
DM2.0389	81637316640	ARM MIRROR CLASS II-IV LH
DM2.0372	81637306560	COMPLETE MIRROR CLASS II-IV LH
DC0.2126	81637306561	COMPLETE MIRROR CLASS II-IV RH ELECTRIC





DC2.3159



DC2.3160

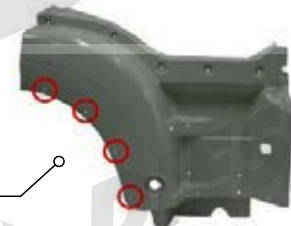

DC2.2809



DC2.3161



DC0.0768



DC2.3583



DC2.3648



DC2.3584



DC0.0772



DC2.3642



DC2.3654



DC2.3651



DC2.3643



DC2.3650



DC2.3652



DC2.3177



DC2.3653



DC2.3655



DC2.3178



The parts referenced in this catalog are not original, but are perfectly adaptable to the models to which they are intended. The use of the manufacturers' marks and the original references is done exclusively for the purpose of indicating the model to which each piece is destined.





DM2.0121



DC0.0830



D0500398



D0500399



DC0.0841



D0600464



DC2.2979



DM2.0061



DM0.2135



DC0.0840



DC2.3012



D0700178



DM2.0356



DC0.0829



DM2.0065



DC2.3011

The parts referenced in this catalog are not original, but are perfectly adaptable to the models to which they are intended.  
The use of the manufacturers' marks and the original references is done exclusively for the purpose of indicating the model to which each piece is destined.



DCO.0828



DCO.0901



DCO.0770

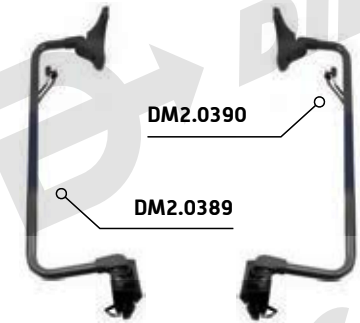

DM2.0390

DM2.0389



DM2.0184



DM2.0368



DM2.0377



DM0.2461



DM2.0185

DM2.0372



DM2.0393  
DM2.0391



DM2.0387  
DM2.0388



DCO.2126



DC2.2409



DM2.0051



DM2.0378



DM2.0369

The parts referenced in this catalog are not original, but are perfectly adaptable to the models to which they are intended. The use of the manufacturers' marks and the original references is done exclusively for the purpose of indicating the model to which each piece is destined.

DIESSA REF.	O.E.M. REF.	DESCRIPTION
DC2.3648	81611106104	CENTRAL GRILLE
DC2.3654	81416106685	CENTRAL BUMPER
DC2.3584	81416105712	SIDE BUMPER RH
DC2.3583	81416105711	SIDE BUMPER LH
DC2.3651	81416105718	SIDE BUMPER RH
DC2.3650	81416105717	SIDE BUMPER LH
DC2.3652	81416105747	BUMPER SUPPORT
DC2.3653	81416106657	LICENSE PLATE HOLDER
DC2.3655	81416106807	BUMPER EXTENSION
DC2.3643	81416105728	HEAD LAMP SEAT RH
DC2.3642	81416105727	HEAD LAMP SEAT LH
DC2.3177	81416106764	UPPER SIDE BUMPER, RH
DC2.3178	81416106763	UPPER SIDE BUMPER, LH
DC2.3159	81615100758,81615100870, 81615100470	FRONT MUDGUARD RH
DC2.2809	81615100757,81615100869, 81615100869	FRONT MUDGUARD LH
DC2.3160	81615100762,81615100598	FRONT MUDGUARD W/HOLE RH
DC2.3161	81615100761,81615100597	FRONT MUDGUARD W/HOLE LH
DC0.0768	81615100474,81615100358	FRONT MUDGUARD RH
DC0.0772	81615100475,81615100845	FRONT MUDGUARD LH
DM2.0121	81615100680,81615100738	STEP PANEL( DARK- GREY), R
DC0.0830	81615100355, 81615100679, 81615100739	FOOTBOARD (WHITE), LH
D0500398	81615100380,81615100736	FOOTBOARD (BLK), R (LX)
D0500399	81615100351,81615100735	FOOTBOARD (BLK), LH (LX)
DC0.0841	81626100032	RH DOOR EXTENSION
DC0.0840	81626100033	LH DOOR EXTENSION
D0600464	81612100462	REAR MUDGUARD RH/LH
DM2.0061	81664106608	FR. RE MUDGUARD
D0700178	81664106606	TOP MUDGUARD W/O STRIPE
DM2.0065	81664106612	TOP MUDGUARD W/O STRAPE
DC2.3012	81612100442	FRONT MUDGUARD REAR PART, RH
DC2.3011	81612100443	FRONT MUDGUARD REAR PART, LH

DIESSA REF.	O.E.M. REF.	DESCRIPTION
DC0.0829	81615100536,81615100443, 81615100468	COVER, STEPWALL
DM2.0356	81664400192	RUBBER STRIPE
DC0.0828	81615105187	LOWER STEP PANEL (R=L)
DC0.0901	81615110001,81615110000	STEP PANEL (RH=LH)
DC0.0770	81615100490,81615100271	LOWER STEP PANEL
DM2.0184	81626416080	OUTSIDE HANDLE W/KEY SET, FRONT RH
DM0.2461	81626416081	OUTSIDE HANDLE W/KEY SET, FRONT LH
DM2.0185	81626416068	INSIDE HANDLE, FRONT RH
DM2.0051	81626416067	INSIDE HANDLE, FRONT LH
DM2.0391	81637306550	COMPLETE MIRROR RH MAIN MIRROR CLASS II ELECTRIC WIDE ANGLE MIRROR CLASS IV ELECTRIC. HEATED SHORT ARM R1200+R300 LHD
DM2.0388	81637306549	COMPLETE MIRROR RH MAIN MIRROR CLASS II ELECTRIC WIDE ANGLE MIRROR CLASS IV ELECTRIC. HEATED SHORT ARM R1200+R300 LHD
DM2.0393	81637306533	COMPLETE MIRROR LH MAIN MIRROR CLASS II ELECTRIC WIDE ANGLE MIRROR CLASS IV MANUAL. HEATED SHORT ARM R1200+R300 LHD
DM2.0387	81637306534	COMPLETE MIRROR RH MAIN MIRROR CLASS II ELECTRIC WIDE ANGLE MIRROR CLASS IV MANUAL. HEATED SHORT ARM R1200+R300 LHD
DM2.0369	81637336071	MIRROR GLASS CLASS II RH=LH HEATED R1200 LHD
DM2.0368	81637336072	MIRROR GLASS CLASS IV WIDE ANGLE RH HEATED R300 LHD
DM2.0377	81637336073	MIRROR GLASS CLASS IV WIDE ANGLE LH HEATED R300 LHD
DC2.2409	81637306578,81637306735, 81637306654	MIRROR ROOF CLASS V RH ELECTRIC HEATED R300 LHD
DM2.0378	81637310356	BACK COVER MIRROR, LH-RH
DM2.0390	81637316641	ARM MIRROR CLASS II-IV RH
DM2.0389	81637316640	ARM MIRROR CLASS II-IV LH
DM2.0372	81637306560	COMPLETE MIRROR CLASS II-IV LH
DC0.2126	81637306561	COMPLETE MIRROR CLASS II-IV RH ELECTRIC
DM0.2135	81664106625,81664106605	RE, RE MUDGUARD
DC2.2979	81664106599	FR. RE MUDGUARD







Calle de la Ciruela 3  
Polígono Industrial El Carralero II  
C.Postal E28222 - Majadahonda  
Madrid - España  
916 347 655  
info@diessa.es

[www.diessa.es](http://www.diessa.es)